

The following steps will demonstrate the easiest installation method while ensuring optimal thermal performance for your project.

In this guide, Foilboard panels are installed between the rafters using Foilboard flexifast fasteners, prior to plastering.

ACCESSORIES



Foilboard Green **OR**
Silver Joining Tape

Foilboard Flexifast
Fasteners

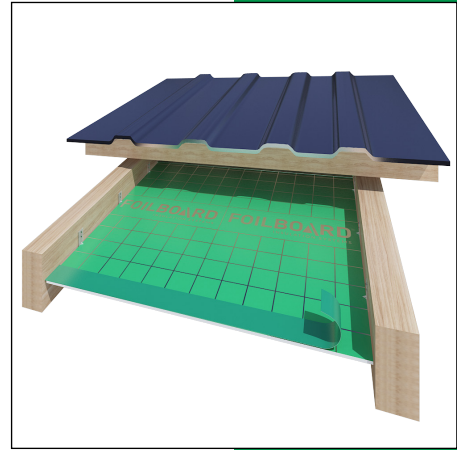

INSTALLATION

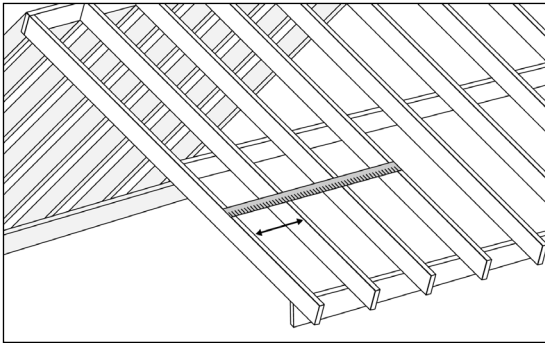

STEP 1 Measure the required area, then mark the Foilboard panel before cutting to size.

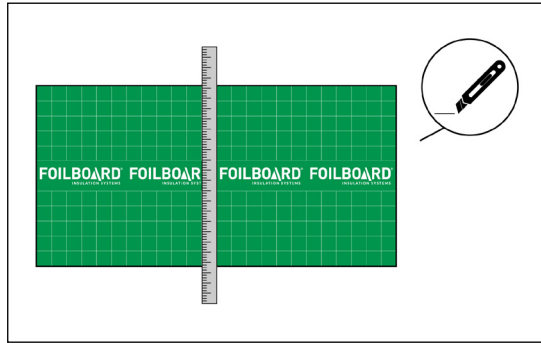

STEP 2 Use full size sheets where possible. For smaller sections, measure the required area and cut with a straight edge for precision.

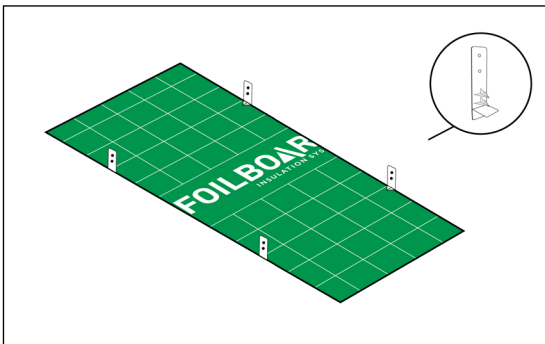

STEP 3 Attach the Foilboard flexifast fasteners to the edges of the panel, 300mm from end and at 600mm intervals.

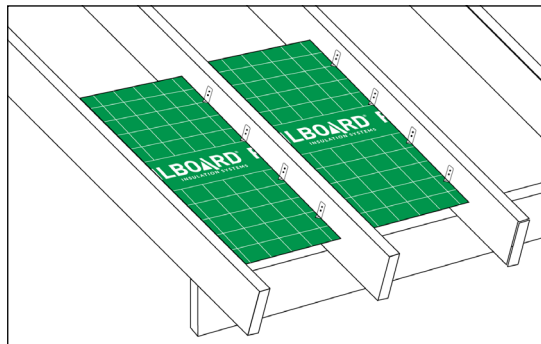

STEP 4 Position the Foilboard panel between the rafters and fix using the fasteners. Ensure the anti-glare side is facing up.

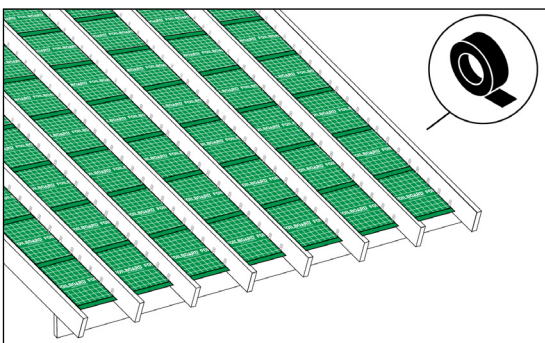

STEP 5 Tape any joints or gaps using Foilboard green or silver joining tape.

PRO TIPS

- When marking out the Foilboard panels, add 2mm to each measurement, this will ensure a snug fit and allow for any slight variation between the rafters.
- Install Foilboard within the exposed rafters and plaster to finish
- Minor gaps can be sealed with a high temperature, water based silicon.

INFORMATION LINE
1800 354 717

www.foilboard.com.au

